

## MULTI-CHANNEL CABLE FREE REMOTE THERMO SENSOR

MODEL: THC138

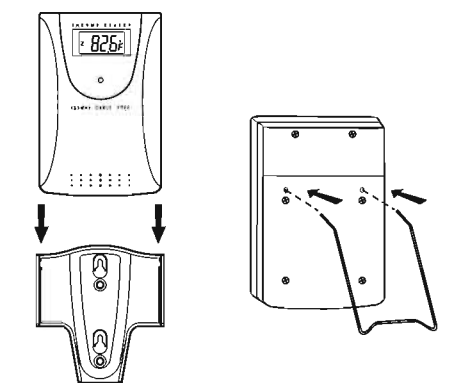
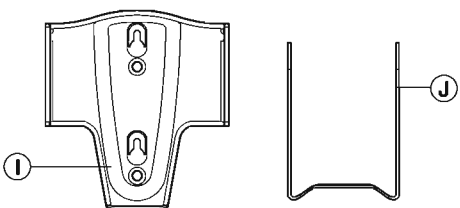
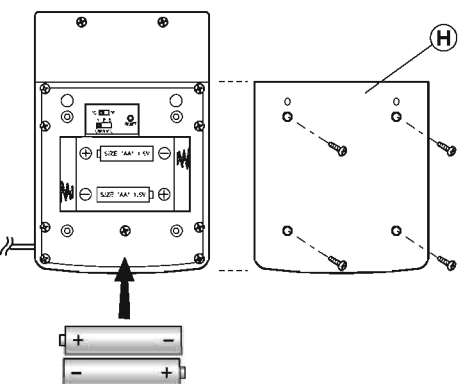
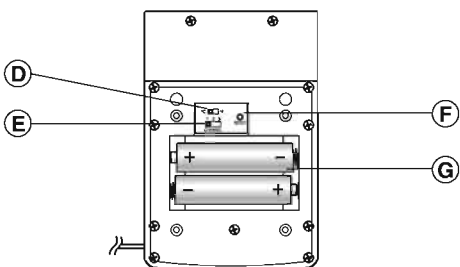
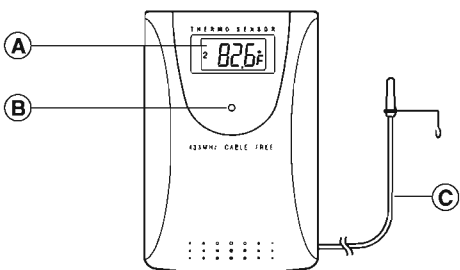

### INTRODUCTION

Congratulations on purchasing the THC-138 Remote Thermo Sensor.

The Remote Thermo Sensor is used with the 433MHz Multi-Channel In-Out Thermometer (Model: EMR812, EMR899, RMR112 or BAR888) to monitor temperature changes of remote or outdoor sites. Operation is easy and no wire installation is required.

### MAIN FEATURES:

- (A) **LCD**  
Displays the current temperature monitored by the remote unit and indicates the selected channel
- (B) **LED INDICATOR**  
Flashes when the remote unit transmits a reading
- (C) **TEMPERATURE SENSOR PROBE**  
On 10 feet (3 meter) cable
- (D) **°C/°F SLIDE SWITCH**  
Selects between Centigrade (°C) and Fahrenheit (°F)
- (E) **CHANNEL SLIDE SWITCH**  
Designates the remote unit Channel 1, Channel 2 or Channel 3
- (F) **RESET BUTTON**  
Returns all settings to default values
- (G) **BATTERY COMPARTMENT**  
Accommodates two AA-size batteries
- (H) **BATTERY DOOR**
- (I) **WALL-MOUNT HOLDER**  
Supports the remote unit in wall-mounting
- (J) **REMOVABLE TABLE STAND**  
For standing the remote unit on a flat surface

### BEFORE YOU BEGIN

For best operation,

- Assign different channels to different remote units.
- Insert batteries for remote units before doing so for the main unit. (Main unit of model EMR899, EMR-899, RMR-112 or BAR-888)
- Place the main unit as close as possible next to the remote unit, and reset the main unit after installing batteries. This will ensure easier synchronization between the transmission and reception of signals.
- Position the remote unit and main unit within effective transmission range, which, in usual circumstances, is 66 to 98 feet (20 to 30 meters).

Note that the effective range is vastly affected by the building materials and where the main and remote units are positioned. Try various set-ups for best result.

Though the sensor is weather proof and meant to be used outdoors, it should be placed away from direct sunlight, rain or snow.

### BATTERY AND CHANNEL INSTALLATION

The remote unit uses two AA-size batteries. To install them,

- Remove the screws on the battery compartment.
- Select the channel number on the CHANNEL slide switch.
- Select the temperature display unit on the °C/°F slide switch.
- Insert the batteries strictly according to the polarities shown inside.
- Replace the battery compartment door and secure its screws.

Standard Alkaline batteries contain significant amounts of water. Because of this they will freeze in low temperatures of approximately 10°F. Disposable Lithium batteries have a much lower threshold for temperature with an estimated freezing range of below -40°F. The Liquid Crystal Display in outdoor thermometers will remain operational to -20°F with adequate power.

Wireless ranges can be impacted by a variety of factors such as extremely cold temperatures. Extreme cold may temporarily reduce the effective range between the sensor and the base station. If the unit's performance fails due to low temperature, the unit will resume proper functioning as the temperature rises to within the normal temperature range (i.e. no permanent damage will occur to the unit due to low temperatures).

### CHANGE CHANNEL

Once a channel is assigned to a unit, you can only change it by removing the batteries and repeating the above procedure.

### LOW-BATTERY WARNING

Replace the batteries of the sensor when the low-battery indicator of the channel represented by the sensor shows up on the main unit.

### OPERATION

Once batteries are in place, the sensor will start transmitting samplings at 30-second intervals.

The current temperature will be shown on the LCD in the selected unit (°C/°F) at the designated channel. The unit (°C/°F) shown on the main unit is determined by the setting on the main unit.

### HOW TO INSTALL THE TEMPERATURE SENSING CABLE

Secure the sensor to an area you want to monitor. Do not expose it to direct sunlight.

### THE RESET BUTTON

See the user manual of your main unit for further information.

This button is only used when the unit is operating in an unfavorable way or malfunctioning. Use a blunt stylus to hold down the button. All settings will return to their default values.

### HOW TO USE THE TABLE STAND OR WALL MOUNT

This sensor comes with a wall-mount holder and a removable stand. Use either to set up the unit.

### PRECAUTIONS

This product is engineered to give you years of satisfactory service if you handle it carefully. Here are a few precautions:

- Do not immerse the unit in water.
- Do not clean the unit with abrasive or corrosive materials. They may scratch the plastic parts and corrode the electronic circuit.
- Do not subject the unit to excessive force, shock, dust, temperature or humidity, which may result in malfunction, shorter electronic life span, damaged battery and distorted parts.
- Do not tamper with the unit's internal components. Doing so will invalidate the warranty on the unit and may cause unnecessary damage. The unit contains no user-serviceable parts.
- Only use fresh batteries as specified in the user manual. Do not mix new and old batteries as the old ones may leak.
- Always read the user manual thoroughly before operating the unit.

### SPECIFICATIONS

#### Temperature Measurement

Displayed range : -58.0°F to 158.0°F  
(-50.0°C to +70.0°C)

Proposed operating range : -22 °F to 140 °F  
(-30 °C to 60 °C)

Temperature resolution : 0.2°F (0.1°C)

RF Transmission Frequency : 433 MHz

No. of Remote unit : Maximum of 3

RF Transmission Range : Maximum 98 feet (30 meters)

Temperature sensing cycle : around 30 seconds

**Power** : use 2 pcs UM-3 or "AA"  
1.5V alkaline batteries

**Weight** : 3.5 ounces (110 grams)

**Dimension** : 4 x 2.7 x 0.8 inches (103 x 68 x 21 mm)

### CAUTION

- The content of this manual is subject to change without further notice.
- Due to printing limitations, the displays shown in this manual may differ from the actual display.
- The manufacturer and its suppliers hold no responsibility to you or any other person for any damage expenses, lost profits, or any other claim as a result of using this product.
- The contents of this manual may not be reproduced without the permission of the manufacturer.

### FCC STATEMENT

This device complies with Part 15 of the FCC Rules. Operation is subject to the following two conditions: (1) This device may not cause harmful interference, and (2) This device must accept any interference received, including interference that may cause undesired operation.

**WARNING** Changes or modifications to this unit not expressly approved by the party responsible for compliance could void the user's authority to operate the equipment.

**NOTE** This equipment has been tested and found to comply with the limits for a Class B digital device, pursuant to Part 15 of the FCC Rules. These limits are designed to provide reasonable protection against harmful interference in a residential installation.

This equipment generates, uses and can radiate radio frequency energy and, if not installed and used in accordance with the instructions, may cause harmful interference to radio communications. However, there is no guarantee that interference will not occur in a particular installation. If this equipment does cause harmful interference to radio or television reception, which can be determined by turning the equipment off and on, the user is encouraged to try to correct the interference by one or more of the following measures:

- Reorient or relocate the receiving antenna.
- Increase the separation between the equipment and receiver.
- Connect the equipment into an outlet on a circuit different from that to which the receiver is connected.
- Consult the dealer or an experienced radio / TV technician for help.